

NOTE:-
THE FROST TOP IS PRE FACTORY SET TO
ACHIEVE TEMPERATURES BETWEEN -8 TO -10°C
WHICH IS THE OPTIMUM TEMPERATURE FOR
PRODUCING FROST ON THE WORKTOP.
PLEASE CHECK WITH WORKTOP MANUFACTURER
THAT THE MATERIAL IS ABLE TO PERFORM WITH
IN THIS TEMPERATURE RANGE.

RECOMMENDED GROOVE SIZE
(TO THE CENTER LINE)

659.0

683.0

RECOMMENDED GROOVE SIZE
(TO THE CENTER LINE)

SOLID SURFACE WORKTOP
SUPPLIED BY OTHERS

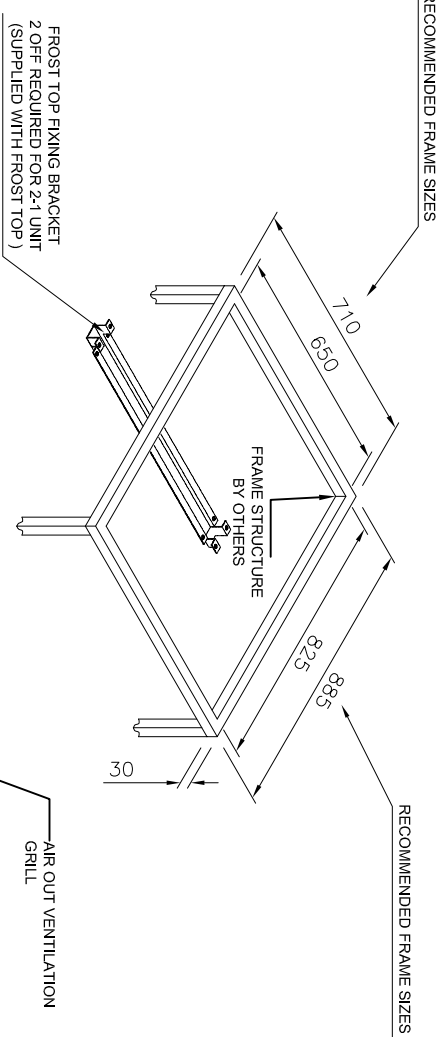
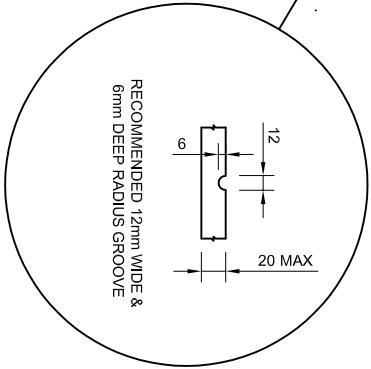

Isometric View

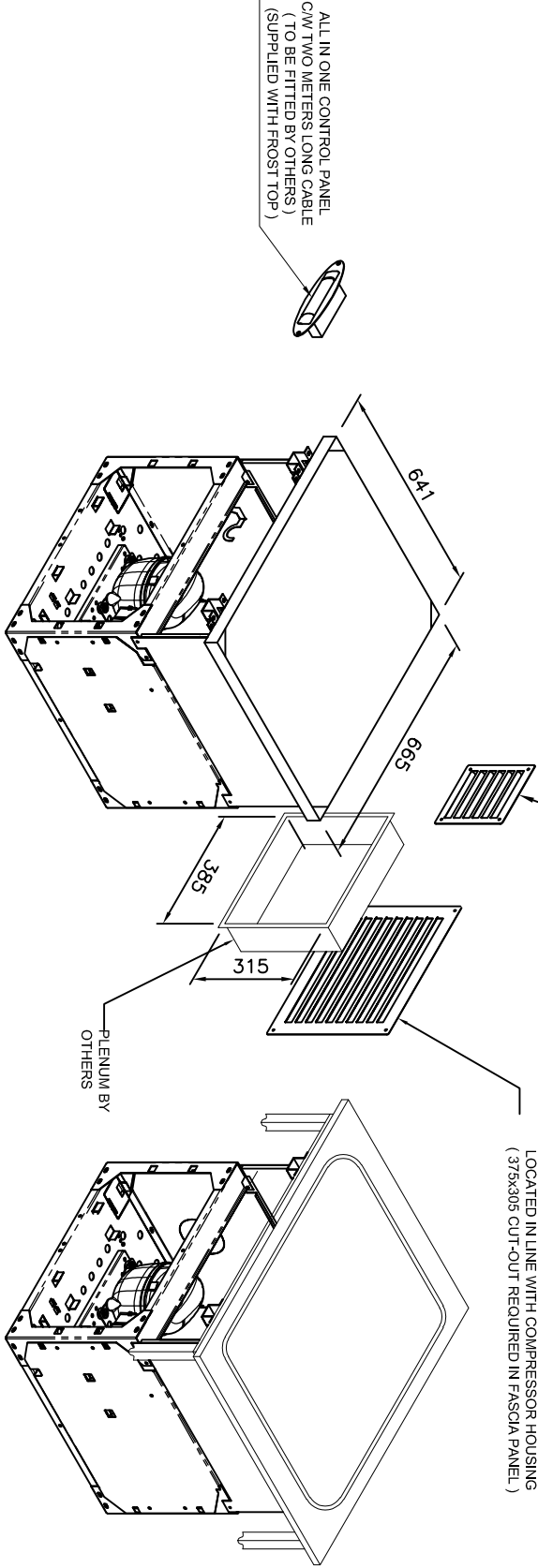

- ### INSTALLATION NOTES :
- TEMPERATURE TRANSFER COMPOUND (SUPPLIED BY CED) TO BE APPLIED EVENLY IN BETWEEN SOLID SURFACE AND FROST TOP.
 - (iii) SILICONE NOT TO BE USED (iii)
 - ADEQUATE DUCTING REQUIRED FOR CORRECT AIR CIRCULATION (BY OTHERS).
 - ELECTRICAL LOAD 3.0kw 13Amp.
 - UNIT SUPPLIED WITH 13A PLUG AND TWO METERS LONG CABLE.
 - GAS CHARGE 0.12 KG (R290).

ALTERNATE FASCIA PANEL ROUTING

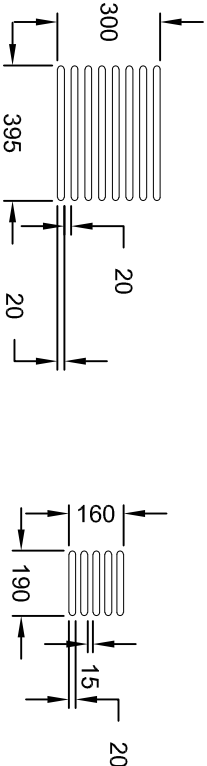

STEEL VENT GRILL AIR-IN
(1 SUPPLIED WITH FROST TOP)

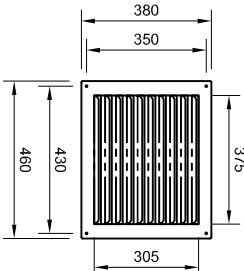

STEEL VENT GRILL AIR-OUT
(1 SUPPLIED WITH FROST TOP)

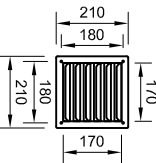

2-1 FROST TOP + AF1 KIT

CUSTOMERS SIDE



AIR OUT



AIR IN

OPERATORS SIDE

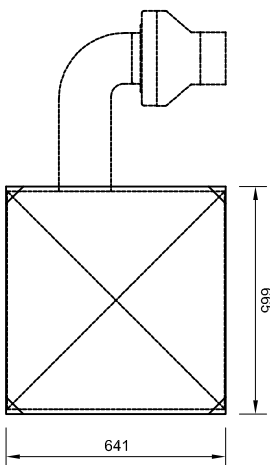

CONTROL PANEL DETAIL

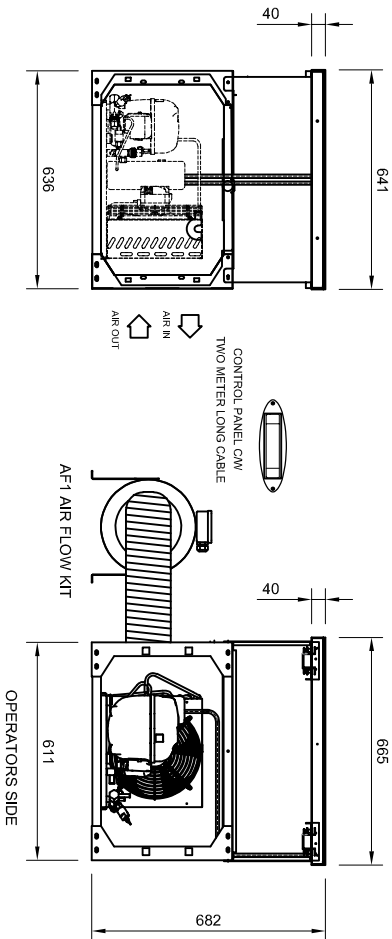
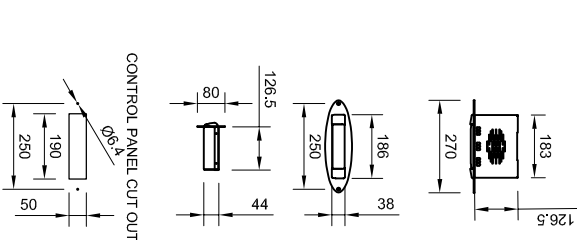

TOLERANCE TABLE		REVISION DETAILS	
1	± 2mm		DATE
1.0	± 0.5mm		
SITE:			
CLIENT:			
DRAWN BY: MG		ORDER No:	REV No:
SCALE: 1:16 @ A2		DATE: 19/06/2018	

DRAWING STATUS AWAITING CLIENT APPROVAL